



EASY-Form System - instructions for use:

INSULATION: First insulate all plastic parts with Interfilm. Remove excessive insulation agent by means of air. Thin coat of Interfilm should suffice.

SYSTEM ASSEMBLY (Fig. 1)

Join the articulation plate with the magnet no. 3, mould no. 2 and the wedge no. 1 consecutively as illustrated on the picture, and tighten all parts with a screw.

PREPARATION OF IMPRESSION (Fig. 2)

Cut off the excess material in the vestibular, lingual or palatal sides.

RELINING (Fig. 3)

When making the upper jaw model, the wedge should be embedded in plasteline, silicone or wax. This may also serve for fixing the impression tray.

STONE (Fig. 4)

Approximately 70-100 g of stone must be mixed for the fabrication of one model. Setting expansion of stone must not exceed 0.1%. We recommend thixotropic, super hard stone, like Interrock New and Interstone New.

FOUNDING (CASTING)

The impression and the Easy-Form are placed upon the vibrator and filled with stone.

Important: the fixing wedge must not be covered with stone for more than 5 mm towards the oral part, so that it may later be extracted.

CAST REMOVAL (Fig. 5)

Once the stone is hardened, the impression and the tightening screw are removed. Articulation plate with the magnet should also be removed.

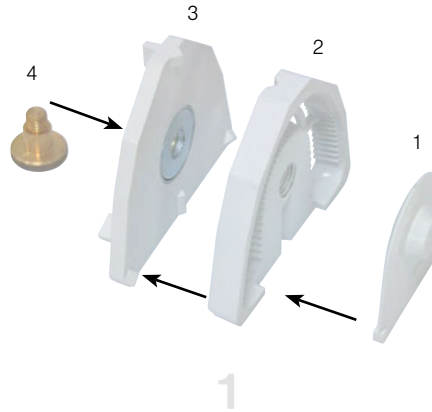

EXTRACTION OF MODEL (Fig. 7,8,9)

Tightening screw should be replaced by the extraction screw. Tightening the extraction screw results in uplifting the stone model. In case the stone model is difficult to extract, the extraction screw should be loosened and distal parts of the stone model pressed with thumbs from below. The wedge is removed by pulling it in distal direction.

TREATMENT OF THE STONE MODEL (Fig. 10,11)

The excess stone is removed from the model by help of the stone cutter, and notches are marked with saw.

Useful tip: first cut is done with the saw manually, then the diamond separating disc is used.

Important: stone model should be cut to several segments, depending on the setting expansion of the stone. This reduces the tension within the model. Each stone segment may not exceed the size of 4 cm.

REASSEMBLY OF PARTICULAR SEGMENTS:

Place the magnetic screw into the plate and arrange particular stone segments according to their symbols. Individual segments are fixed by the wedge. The accuracy of distributed segments may be controlled by means of the control outline upon the wedge.

PLACEMENT INTO THE ARTICULATOR

To place the model into the articulator simply bring the articulation plate and the mould with the stone model together (Split-Cast-System).

Important: Easy - Form components may not be heated over 60 °C, nor splashed with boiling water.

